

\$269,900 - 6114 76a Street, Rural Grande Prairie No. 1, County of

MLS® #A2096811

\$269,900

0 Bedroom, 0.00 Bathroom,
Land on 0.46 Acres

Maple Ridge Estates, Rural Grande Prairie No. 1, County of, Alberta



Welcome to beautiful Maple Ridge Estates. Situated minutes from the city of Grande Prairie, this premier community features 0.5 acre-2.5 acre lots on city services. Features of this amazing community include treed lots, paved walking trails, a beautiful water features, county taxes and a caring community of neighbours that are there to help and take pride in Maple Ridge. We are down to the last 12 lots before Maple Ridge is sold out. Call today to get more details on this spectacular community.

Essential Information

MLS® #	A2096811
Price	\$269,900
Bathrooms	0.00
Acres	0.46
Type	Land
Sub-Type	Residential Land
Status	Active

Community Information

Address	6114 76a Street
Subdivision	Maple Ridge Estates
City	Rural Grande Prairie No. 1, County of
County	Grande Prairie No. 1, County of

Province Alberta
Postal Code T8X 1L4

Additional Information

Date Listed December 4th, 2023
Days on Market 560
Zoning RE

Listing Details

Listing Office Grassroots Realty Group Ltd.

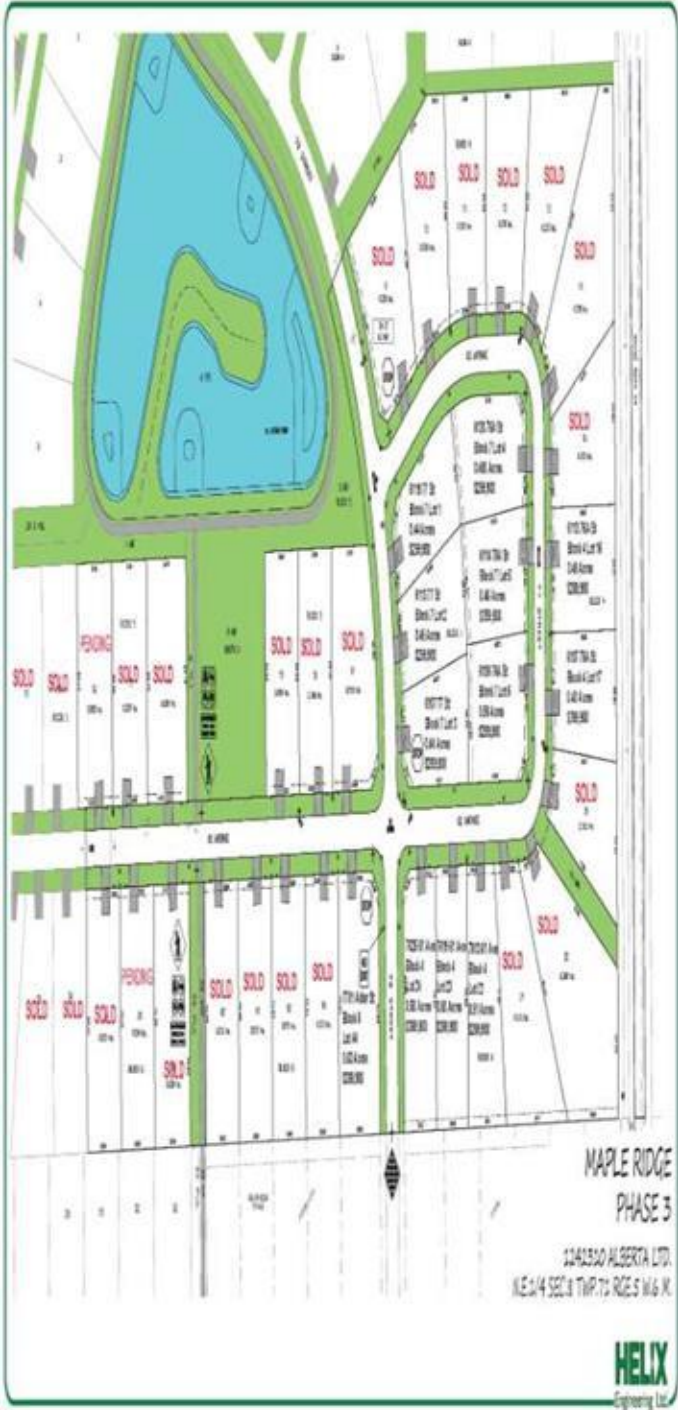

Data is supplied by Pillar 9â„¢ MLSÂ® System. Pillar 9â„¢ is the owner of the copyright in its MLSÂ® System. Data is deemed reliable but is not guaranteed accurate by Pillar 9â„¢. The trademarks MLSÂ®, Multiple Listing ServiceÂ® and the associated logos are owned by The Canadian Real Estate Association (CREA) and identify the quality of services provided by real estate professionals who are members of CREA. Used under license.