

\$269,900 - 6107 77 Street, Rural Grande Prairie No. 1, County of

MLS® #A2096809

\$269,900

0 Bedroom, 0.00 Bathroom,
Land on 0.44 Acres

Maple Ridge Estates, Rural Grande Prairie No. 1, County of, Alberta



Welcome to beautiful Maple Ridge Estates. Situated minutes from the city of Grande Prairie, this premier community features 0.5 acre-2.5 acre lots on city services. Features of this amazing community include treed lots, paved walking trails, a beautiful water features, county taxes and a caring community of neighbours that are there to help and take pride in Maple Ridge. We are down to the last 12 lots before Maple Ridge is sold out. Call today to get more details on this spectacular community.

Essential Information

MLS® #	A2096809
Price	\$269,900
Bathrooms	0.00
Acres	0.44
Type	Land
Sub-Type	Residential Land
Status	Active

Community Information

Address	6107 77 Street
Subdivision	Maple Ridge Estates
City	Rural Grande Prairie No. 1, County of
County	Grande Prairie No. 1, County of

Province

Postal Code

Additional Information

Date Listed

Days on Market

Zoning

Listing Details

Listing Office

Alberta

T8X 1L4

December 4th, 2023

560

RE

Grassroots Realty Group Ltd.

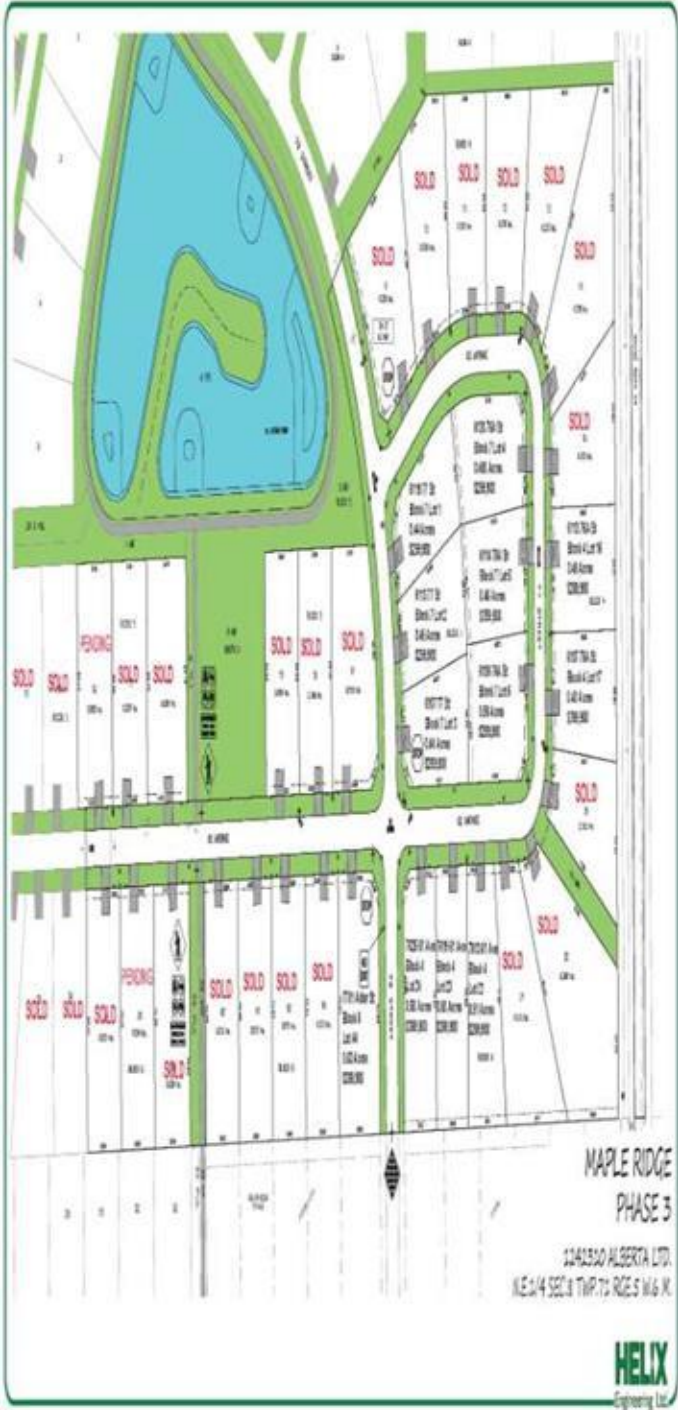

Data is supplied by Pillar 9â„¢ MLSÂ® System. Pillar 9â„¢ is the owner of the copyright in its MLSÂ® System. Data is deemed reliable but is not guaranteed accurate by Pillar 9â„¢. The trademarks MLSÂ®, Multiple Listing ServiceÂ® and the associated logos are owned by The Canadian Real Estate Association (CREA) and identify the quality of services provided by real estate professionals who are members of CREA. Used under license.